

DRY PILLAR FIRE HYDRANTS



CERTIFICATE NO:463
(Ref redbooklive.com)



DESIGN SPECIFICATIONS

SHELL MATERIAL

Spheroidal graphite cast iron. (Ductile Iron)

OBTURATOR

- The design of obturator (base valve) in hydrant is made in such way that it can be replaced at site.
- Material of base valve is high tensile brass.

RESISTANCE TO DYSFUNCTION PRODUCTS

Hydrant is built to withstand misuse that may cause dysfunctional failures.

INLET FLANGED TO BS EN 1092-2

CORROSION PROTECTION

All ferrous components liable to corrode are prepared and coated as detail below:

SURFACE PREPARATION:

Each hydrant is shot blasted (inside & outside)

PAINT SYSTEM

- **INSIDE:** barrel inside and rod coated with 3 coat epoxy paint system, minimum 250 microns DFT.
- **OUTSIDE:** Outside coating top portion primer coating and red polyurethane coating, minimum 250 microns. Bottom portion outside two coat black bituminous coating, minimum 250 microns.

FIELD OF APPLICATION

- Fire fighting purpose.
- Suitable for non-potable water supply purpose only.

FEATURES

- BSI-KITEMARK, LPCB approved
- NAFFCO Fire Hydrants are manufactured to comply BS EN 14384: 2005, BS 1074-1, BS 1074-2 & BS 1074-6 Standards.
- Dry barrel design eliminates damage to the hydrant caused by freezing of the upper part.
- NAFFCO Fire Hydrants are designed for high performance and easy to install, maintain and repair.
- Excellent and proven flow characteristics.
- 2 x 2½" gate valve with female instantaneous outlet to BS 336:2010.
- Body material made of spheroidal graphite cast iron (Ductile Iron) to BS 1563:2011.
- 2 x 2½" Female Instantaneous quick coupling adaptor to BS 336:2010, flanged inlet to BS EN 1092-2
- 1 x 4" Male/Female BSRT pumper to BS 336:2010.
- Aluminum Hood/GRP cover is provided for protection and misusing.
- Operation threads are corrosion protected and for easy operation.
- NAFFCO Fire Hydrants are high Pressure rating to 16 bar.
- Drain starts automatically when hydrant is closed.
- Internal epoxy paint system gives high corrosion protection to hydrants.
- Hydrant protective covers with handle for easy handling.

**for LPCB approved - Hydrant Model NFHV Series with 2 x 2½" straight through landing valve available upon request.*

**Inside Blue FBE coating with WRAS approval & external powder coating available upon request*

GENERAL DIMENSIONAL DETAILS

SL.No.	Model No.	Inlet Flange Size in inch (DN)	Dimensions in mm		Working Pressure
			A	B	

NHC SERIES

1	100 NHC-800	4 (100)	1515	530	16
2	100 NHC-1200	4 (100)	1915	530	16

NFHV SERIES*

1	100 NFHV-800	4 (100)	1450	430	16
2	100 NFHV-1200	4 (100)	1850	430	16
3	150 NFHV-800	6 (150)	1500	480	16
4	150 NFHV-1200	6 (150)	1900	480	16

NFHQ SERIES

1	100 NFHQ-800	4 (100)	1450	430	16
2	100 NFHQ-1200	4 (100)	1850	430	16
3	150 NFHQ-800	6 (150)	1500	480	16
4	150 NFHQ-1200	6 (150)	1900	480	16

NFHQC SERIES

1	100 NFHQC-800	4 (100)	1450	430	16
2	100 NFHQC-1200	4 (100)	1850	430	16
3	150 NFHQC-800	6 (150)	1500	480	16
4	150 NFHQC-1200	6 (150)	1900	480	16

NFHQS-CD SERIES

1	100 NFHQS-CD 800	4 (100)	1450	430	16
2	100 NFHQS-CD 1200	4 (100)	1850	430	16
3	150 NFHQS-CD 800	6 (150)	1500	480	16
4	150 NFHQS-CD 1200	6 (150)	1900	480	16

NFHQM SERIES

1	150 NFHQM-800	6 (150)	1500	480	16
2	150 NFHQM-1200	6 (150)	1900	480	16

NFHQV-CD SERIES

1	100 NFHQV-CD1	--	960	430	--
2	100 NFHQV-CD2	--	1360	430	--
3	150 NFHQV-CD1	--	960	480	--
4	150 NFHQV-CD2	--	1360	480	--

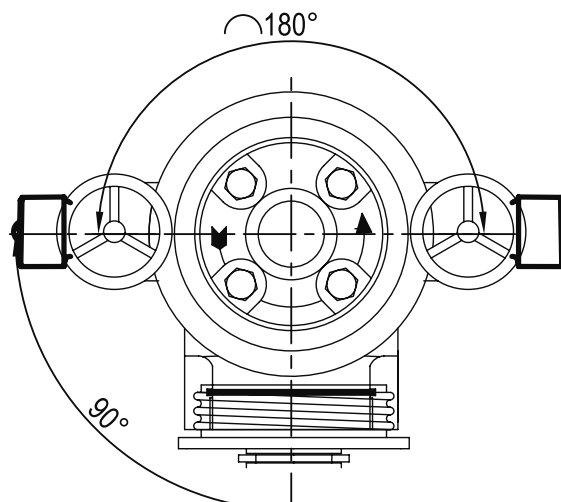

150 NFHQV-CD

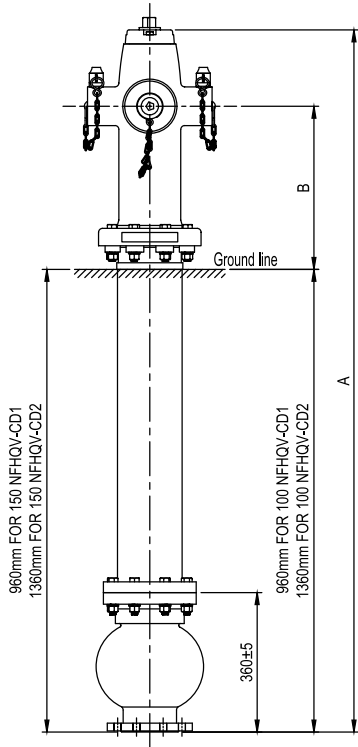

NHC

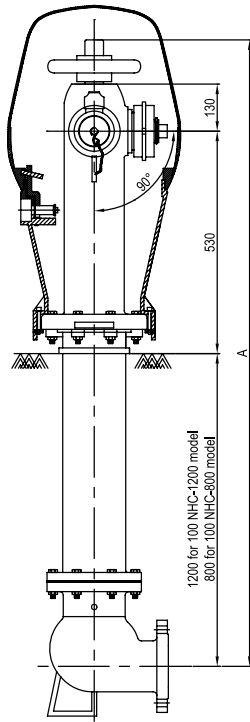

NFHV

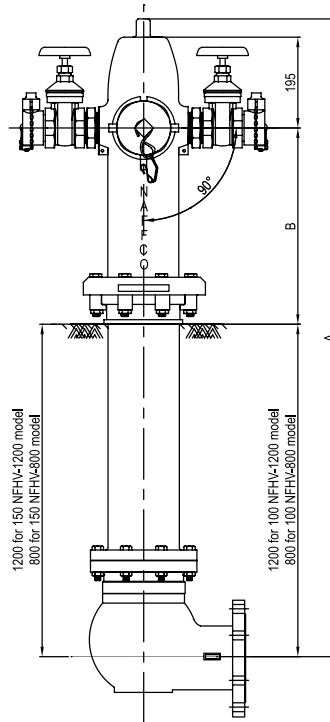

NFHQ

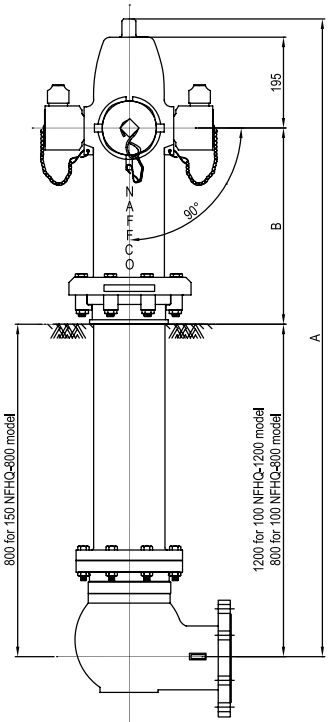

NFHQC

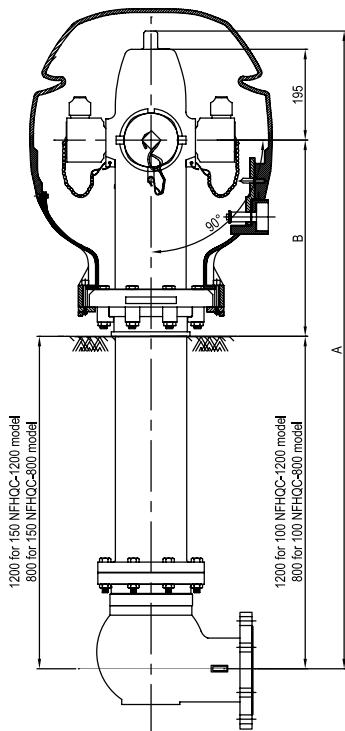

NFHQS-CD

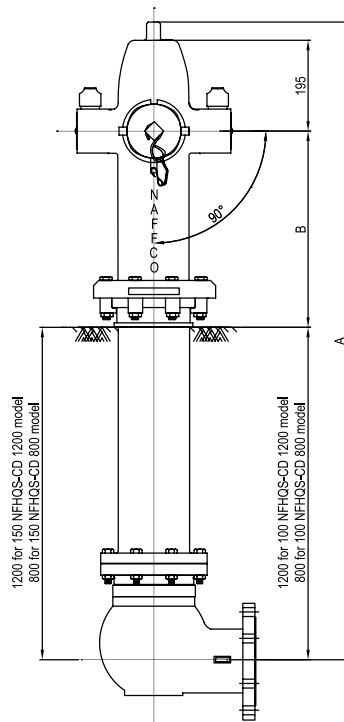

NFHQM

